

Release Notes

FinishLynx 13.10

Obtaining Lynx Products and Information	1
Obtaining Technical Support	1
What's New	2
Auto-Focus	2
Vision PRO X Enhancements	2
General Improvements	2
Scoreboard Improvements	3
ADVANCED - Other Settings	3

Obtaining Lynx Products and Information

There are three ways to obtain Lynx products and information:

- » Go to the Lynx website (<http://www.finishlynx.com/product/>)
- » Call (978) 556-9780 and ask to speak with someone in sales, or
- » Send an email to...
 - » Domestic Sales: domsales@finishlynx.com
 - » International Sales: intlsales@finishlynx.com

Obtaining Technical Support



There are four ways to obtain technical support for Lynx products:

- » Go to the Lynx website (<http://www.finishlynx.com/support/>)
- » Find our latest video tutorials on YouTube (<https://www.youtube.com/c/FinishLynx/videos>)
- » Call (978) 556-9780 and ask to speak with someone in tech support, or
- » Send an email to...
 - » Technical support: support@finishlynx.com





What's New

Auto-Focus

EtherLynx cameras equipped with a remote control lens now support the *Auto-Focus* functionality. To start *Auto-Focus* simply hold **Ctrl+Shift** and click either the *Focus Near*  or *Focus Far*  button while in *2D EasyAlign* mode.

TIP: Right-click and drag your mouse to draw a box around the region you want the focus to be centered from.

- » For optimal results when using a C-Mount or mechanical iris F-Mount lenses:
 1. Check the **AEC** box.
 2. Open the iris as much as possible without overexposing the image.
 3. Hold **Ctrl+Shift** and click either the *Focus Near*  or *Focus Far*  button while in *2D EasyAlign* mode.

NOTE: To stop Auto-Focus while in progress, either stop alignment mode or hit ESC.

Vision PRO X Enhancements

The Vision PRO X now supports:

- » Video Display Module (**VDM**)
 - » **Note:** Requires 2026 hardware revision.
- » **EVF** over HDMI (see Advanced - Other Settings below)
 - » **Note:** Requires 2026 hardware revision.
- » Camera runtime environment update- automatic double-boot to update the camera when **FinishLynx** detects required firmware updates.
- » **BOOT LED** behavior - solid **Amber** between initial boot (**Red**) and ready to connect (slow flash **Amber**)

General Improvements

Image

- » Zoom out to **2%** and **3%** in image panes
- » *Zoom* selectors for **1/2**, **1/4**, **1/8** image size on **Image|Print** and **Image|Print to Bitmap** dialogs.
- » Updated *Finnish* LNG

Capture

- » *Photoeye A* capture method now supports the **Pre-Cropped** feature.

Scoreboard Improvements

Force Stop

The **Force Stop** option, when checked, will cause the running time to stop as soon as results (Time field) are available. If Results are set to Auto (or Manual), they will appear immediately, even if you are not using a photoeye, or forgot to arm your photoeye.

- » To enable **Force Stop**:
 - » Go to **Scoreboard|Options...** and select your scoreboard object from the list.
 - » Click the **Options** sub-menu in the **Running Time**: section.
 - » Select **Force Stop**.

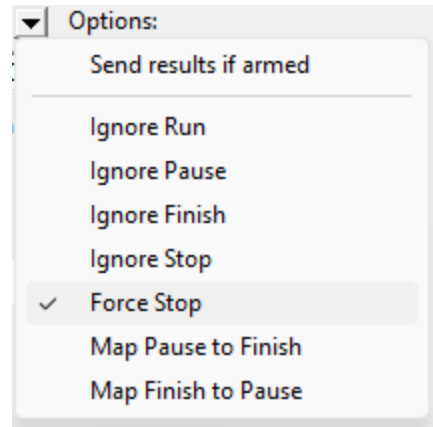

Scripts

- » Added Wavelight.lss
- » Add uTabLED_Wind.lss
- » Added \13\10 'Length time' to ResultsHeader section

NOTE: Run FinishLynx as Administrator (right-click shortcut + Run As Administrator) for best performance.

TIP: For more information, check out our video tutorials on [YouTube](#).

ADVANCED - Other Settings

Additional *Other (hidden) settings* are included:

- » **Event\Image\CacheSize** increased to 100MB.
- » **Hardware\Ethernet\Display\EVFType** 0=HDMI; 1=Wifi (5L700 only - requires reboot and restart)
- » **Hardware\Ethernet\Display\EVFIAddr:** sets the host IP address of the EVF-Wifi network.
- » **Hardware\Focus\AutoFocus** includes multiple variables to control the Auto-Focus function.
- » **Hardware\Remote\IrisCtrlOride** overrides the automatic f-mount lens type detection for remote iris.

